

# 日成 型铜管端子

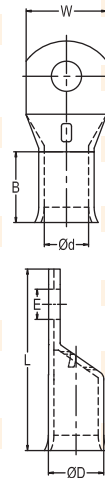

型号	尺寸 DIMENSION					
S-TT-6/4	4.3	5.5	3.8	10.3	11.0	25.0
S-TT-6/5	5.3	5.5	3.8	10.3	11.0	25.0
S-TT-6/6	6.4	5.5	3.8	10.3	11.0	26.0
S-TT-6/8	8.3	5.5	3.8	14.0	11.0	29.0
S-TT-10/4	4.3	6.8	4.7	11.9	11.5	26.5
S-TT-10/5	5.3	6.8	4.7	11.9	11.5	27.0
S-TT-10/6	6.4	6.8	4.7	11.9	11.5	28.5
S-TT-10/8	8.3	6.8	4.7	15.0	11.5	31.5
S-TT-10/10	10.5	6.8	4.7	18.0	11.5	35.5
S-TT-16/5	5.3	7.8	5.6	11.9	16.5	32.0
S-TT-16/6	6.4	7.8	5.6	11.9	16.5	34.0
S-TT-16/8	8.3	7.8	5.6	15.0	16.5	36.5
S-TT-16/10	10.5	7.8	5.6	18.0	16.5	40.0
S-TT-25/6	6.4	9.4	7.1	13.5	18.0	36.0
S-TT-25/8	8.3	9.4	7.1	15.0	18.0	39.0
S-TT-25/10	10.5	9.4	7.1	18.0	18.0	44.0
S-TT-25/12	13.0	9.4	7.1	21.0	18.0	46.0
S-TT-35/6	6.4	11.3	8.7	16.0	19.0	37.0
S-TT-35/8	8.3	11.3	8.7	16.0	16.0	38.0
S-TT-35/10	10.5	11.3	8.7	19.0	19.0	45.0
S-TT-35/12	13.0	11.3	8.7	21.0	19.0	47.0
S-TT-50/6	6.4	12.6	9.8	17.9	22.0	44.0
S-TT-50/8	8.3	12.6	9.8	17.9	22.0	46.0
S-TT-50/10	10.5	12.6	9.8	20.0	22.0	50.0
S-TT-50/12	13.0	12.6	9.8	21.0	22.0	54.0
S-TT-70/8	8.3	14.7	11.5	21.5	23.0	49.0
S-TT-70/10	10.5	14.7	11.5	21.5	25.0	55.0
S-TT-70/12	13.0	14.7	11.5	21.5	23.0	55.0
S-TT-95/8	8.3	16.9	13.5	24.7	30.0	58.0
S-TT-95/10	10.5	16.9	13.5	24.7	30.0	61.0
S-TT-95/12	13.0	16.9	13.5	24.7	30.0	63.0
S-TT-95/14	14.5	16.9	13.5	24.7	30.0	67.0
S-TT-95/16	16.5	16.9	13.5	27.0	30.0	70.0
S-TT-120/10	10.5	19.9	15.6	28.9	30.5	62.0
S-TT-120/12	13.0	19.9	15.6	28.9	30.5	67.0
S-TT-120/14	14.5	19.9	15.6	28.9	30.5	74.0
S-TT-120/16	16.5	19.9	15.6	28.9	30.5	74.0
S-TT-150/10	10.5	20.9	16.5	30.4	38.0	75.0
S-TT-150/12	13.0	20.9	16.5	30.4	38.0	81.0
S-TT-150/14	14.5	20.9	16.5	30.4	38.0	85.0
S-TT-150/16	16.5	20.9	16.5	30.4	38.0	85.0
S-TT-185/12	13.0	23.7	18.8	34.0	41.0	87.0
S-TT-185/14	14.5	23.7	18.8	34.0	41.0	91.0
S-TT-185/16	16.5	23.7	18.8	34.0	41.0	92.0
S-TT-240/12	13.0	26.2	21.2	38.4	45.0	93.0
S-TT-240/14	14.5	26.2	21.2	38.4	45.0	97.0
S-TT-240/16	16.5	26.2	21.2	38.4	45.0	98.0
S-TT-240/20	21.0	26.2	21.2	38.4	45.0	98.0
S-TT-300/14	14.5	28.6	23.4	41.7	49.0	100.0
S-TT-300/16	16.5	28.6	23.4	41.7	49.0	106.0
S-TT-400/16	16.5	32.8	26.8	47.8	54.0	115.0

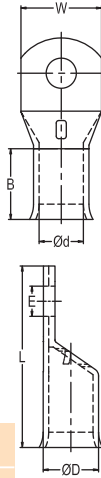

型号	尺寸 DIMENSION					
TT10-6	6.4	6.9	4.7	11.9	12.0	28.0
TT10-8	8.3	6.9	4.7	13.5	12.0	31.0
TT16-6	6.4	7.8	5.6	11.9	17.0	33.0
TT16-8	8.3	7.8	5.6	13.5	17.0	37.0
TT16-10	10.5	7.8	5.6	16.0	17.0	38.0
TT25-8	8.3	9.5	7.1	14.0	18.0	39.0
TT25-10	10.5	9.5	7.1	16.0	18.0	42.0
TT35-8	8.3	11.0	8.2	16.5	19.0	42.0
TT35-10	10.5	11.0	8.2	16.5	19.0	46.0
TT50-10	10.5	12.5	9.5	17.9	22.0	51.0
TT50-12	13.0	12.5	9.5	17.9	22.0	51.0
TT70-10	10.5	15.0	11.5	22.0	22.0	54.0
TT70-12	13.0	15.0	11.5	22.0	22.0	54.0
TT95-14	14.5	17.0	13.5	24.7	27.0	72.0
TT95-16	16.5	17.0	13.5	24.7	27.0	72.0
TT120-14	14.5	20.0	15.6	28.9	29.0	74.0
TT120-16	16.5	20.0	15.6	28.9	29.0	74.0
TT150-14	14.5	21.0	16.5	30.4	28.0	84.0
TT150-16	16.5	21.0	16.5	30.4	28.0	84.0
TT185-16	16.5	23.6	18.4	34.0	42.0	92.0
TT240-16	16.5	26.4	21.2	41.0	45.0	98.0